



Wafer type (W)

Lug type (L)

Nominal Pressure: PN 10 / 16

Body: GGG 40.3 (0.7043)

Coating: Epoxy resin

Lining: PTFE-Liner (3 mm)

Centrally mounted disc:

PTFE-coated (Type 111)

Stainless Steel (Type 113)

Face to face acc. to DIN 3202, K1 / EN 558-1, GR20

Leakage rate A acc. to EN 12266-1/P11+12

Tests/Certificates: TA-Luft acc. to VDI 2440, SIL 3 acc. to EN 61508

Nominal diameter	PTFE/PTFE		PTFE/stainless steel	
	Wafer type (W)	Lug type (L)	Wafer type (W)	Lug type (L)
DN50	AK-111-W-MT-50	AK-111-L-MT-50	AK-113-W-MT-50	AK-113-L-MT-50
DN65	AK-111-W-MT-65	AK-111-L-MT-65	AK-113-W-MT-65	AK-113-L-MT-65
DN80	AK-111-W-MT-80	AK-111-L-MT-80	AK-113-W-MT-80	AK-113-L-MT-80
DN100	AK-111-W-MT-100	AK-111-L-MT-100	AK-113-W-MT-100	AK-113-L-MT-100
DN125	AK-111-W-MT-125	AK-111-L-MT-125	AK-113-W-MT-125	AK-113-L-MT-125
DN150	AK-111-W-MT-150	AK-111-L-MT-150	AK-113-W-MT-150	AK-113-L-MT-150
DN200	AK-111-W-MT-200	AK-111-L-MT-200	AK-113-W-MT-200	AK-113-L-MT-200
DN250	AK-111-W-MT-250	AK-111-L-MT-250	AK-113-W-MT-250	AK-113-L-MT-250
DN300	AK-111-W-MT-300	AK-111-L-MT-300	AK-113-W-MT-300	AK-113-L-MT-300
DN350	AK-111-W-MT-350	AK-111-L-MT-350	AK-113-W-MT-350	AK-113-L-MT-350
DN400	AK-111-W-MT-400	AK-111-L-MT-400	AK-113-W-MT-400	AK-113-L-MT-400
DN450	AK-111-W-MT-450	AK-111-L-MT-450	AK-113-W-MT-450	AK-113-L-MT-450
DN500	AK-111-W-MT-500	AK-111-L-MT-500	AK-113-W-MT-500	AK-113-L-MT-500
DN600	AK-111-W-MT-600	AK-111-L-MT-600	AK-113-W-MT-600	AK-113-L-MT-600



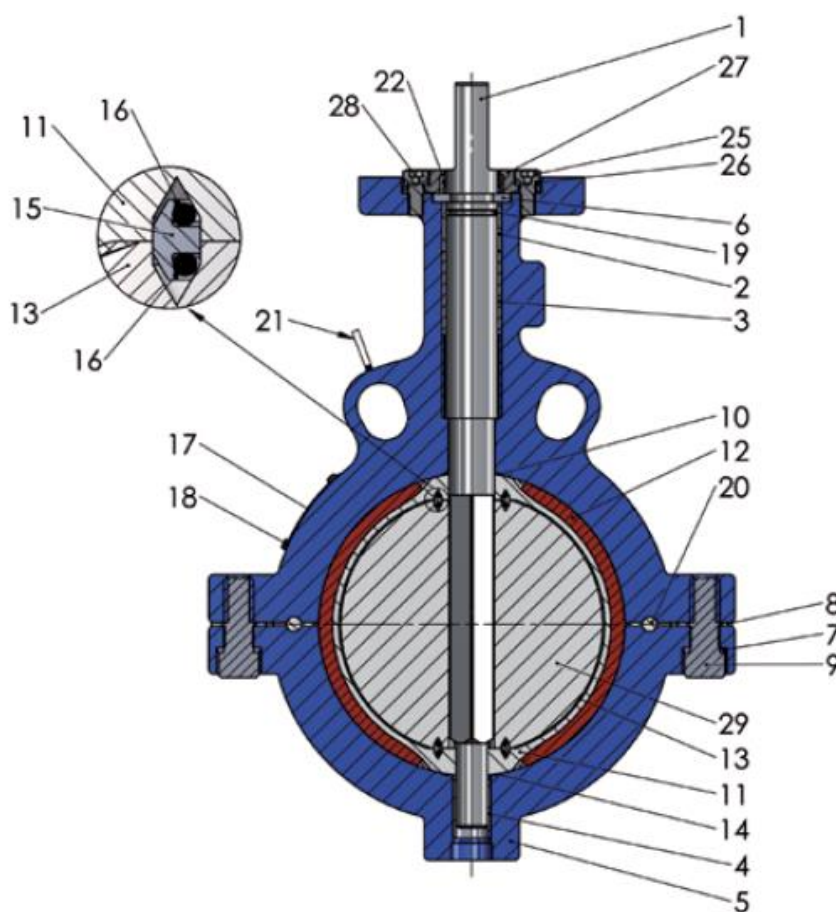

Pos.	Qty.	Material	Part Name	Pos.	Qty.	Material	Part Name
1	1	1.4313 up to DN 300 1.4021 from DN 350	Shaft	15	2	PTFE	Sealring
2	1	Steel/PTFE	Slide bushing (top)	16	4	Viton	O-Ring (Sealring)
3	2	Steel/PTFE	Slide bushing (center)	17	1	Stainless steel	Nameplate
4	1	Steel/PTFE	Slide bushing (bottom)	18	4	Stainless steel	Rivet
5	1	GGG 40.3 (0.7043)	Body	19	1	Viton	O-Ring
6	1	PTFE, carbon reinf.	Retaning ring (split)	20	2	PTFE	Security element
7	2	Stainless steel	Spring washer	21	1	Steel electroplated	Ground connection
8	2	GYLON	Washer	22	2	Viton	O-Ring (adapter flange)
9	1	Stainless steel	Body screw	23	1	Stainless steel/Viton	Gasket
10	1	GYLON	Top gasket	24	1	Stainless steel	Closure
11	1	PTFE	Lining	25	4	Stainless steel	Screw
12	2	Silicone	Elastomer backup-element	26	4	Stainless steel	Spring washer
13	1	PTFE or stainless steel (1.4581)	Disc	27	1	Stainless steel	Head flange
14	1	GYLON	Bottom gasket	28	1	GYLON	Seal (adapter flange)
				29	1	GGG 40 (0.7040)	Disc insert

Dimensions Wafer type W

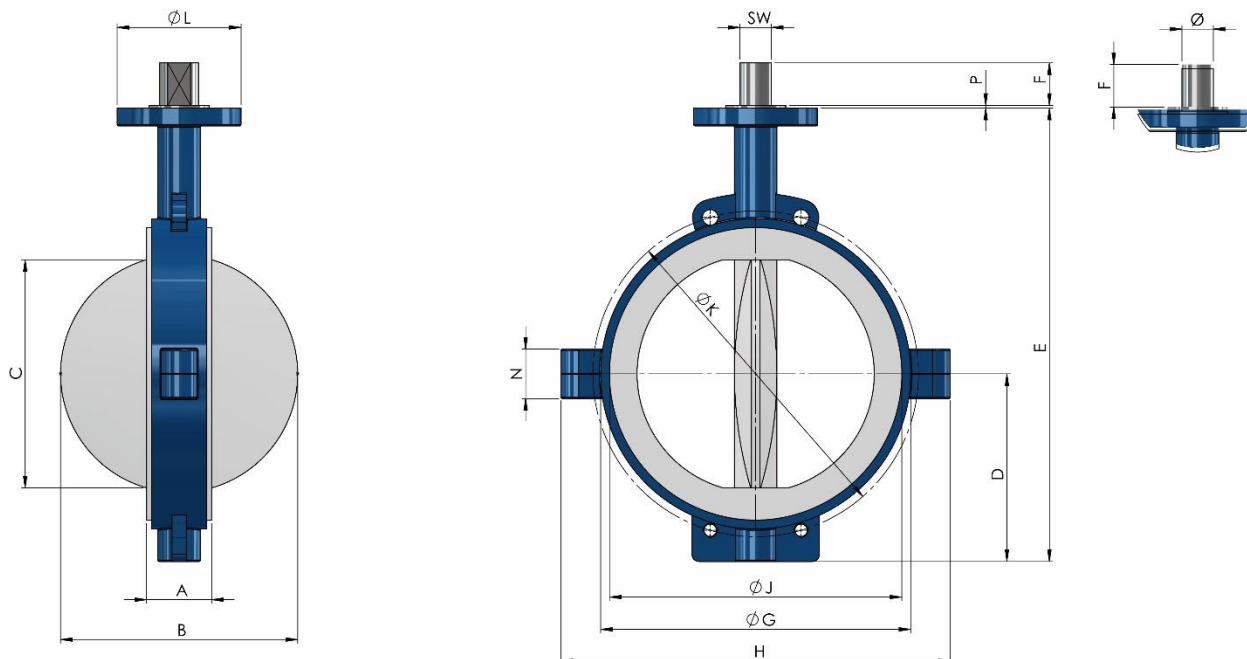

DN		Head flange	A	B	C	D	E	F	G	H	J	K		L	SW Ø	P	N	Weight Kg
Inch	mm											DIN PN10	ANSI					
2	50	F 05	43	60	43	62	202	35	102	152	98	125	121	65	10,0	3	40	2,60
2½	65	F 05	46	70	53	70	220	35	121	171	120	145	140	65	10,0	3	40	3,60
3	80	F 05	46	82	67	79	244	35	133	183	127	160	152	65	10,0	3	40	3,80
4	100	F 07	52	106	93	95	275	35	162	214	159	180	190	90	13,0	3	50	6,20
5	125	F 07	56	128	115	108	303	35	192	248	187	210	216	90	13,0	3	50	8,60
6	150	F 10	56	157	147	121	336	40	218	290	216	240	241	125	17,0	3	56	11,60
8	200	F 10	60	197	188	150	395	40	273	350	270	295	298	125	17,0	3	56	17,40
10	250	F 12	68	246	236	179	459	50	328	405	324	350	362	150	22,0	3	60	30,60
12	300	F 12	78	295	284	216	536	50	378	455	375	400	432	150	22,0	3	70	38,30
14	350	F 14	92	335	322	265	640	60	438	550	413	460	476	175	44,4	4	70	71,50
16	400	F 14	102	387	374	305	725	60	489	570	470	515	540	175	44,4	4	70	90,60
18	450	F 16	114	430	415	320	780	80	539	670	533	565	578	210	44,4	4	70	113,00
20	500	F 16	127	484	467	355	865	80	594	690	584	620	635	210	44,4	4	70	163,50
24	600	F 25	154	578	558	415	990	90	695	820	692	725	749	300	63,5	5	76	254,00

8	200	for PN 16 > DN 150	295						
10	250		355						
12	300		410						

Dimensions Lug type L

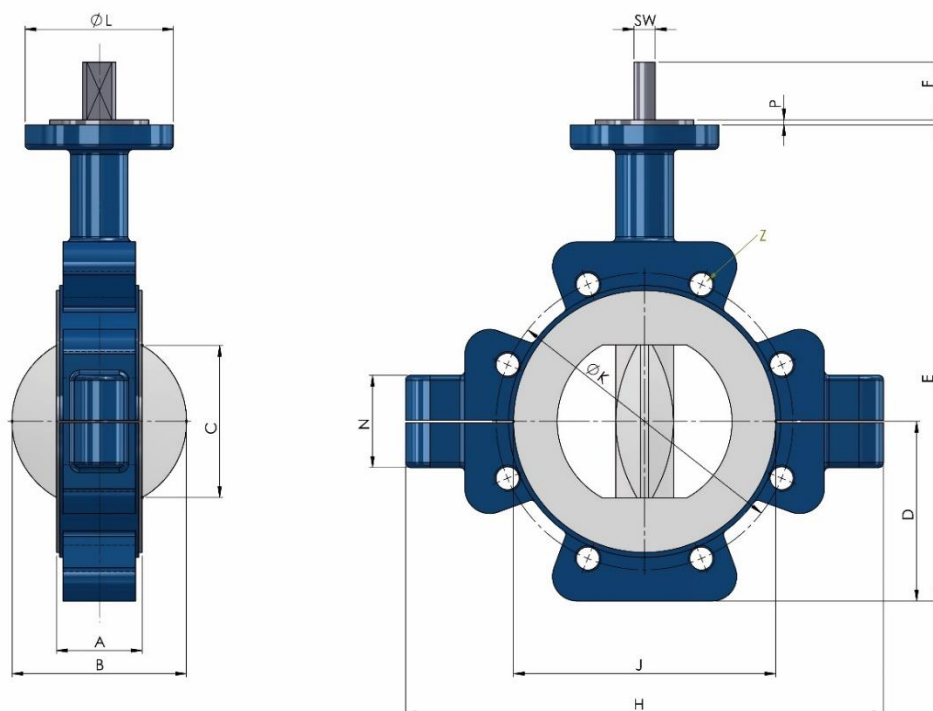

DN		Head flange	A	B	C	D	E	F	H	J	K		L	SW Ø	P	N	Weight Kg
Inch	mm										DIN PN10	ANSI					
2	50	F 05	43	60	43	62	202	35	170	98	125	121	65	10,0	3	45	3,60
2½	65	F 05	46	70	53	70	220	35	193	120	145	140	65	10,0	3	45	4,50
3	80	F 05	46	82	67	91	256	35	252	127	160	152	65	10,0	3	56	7,10
4	100	F 07	52	106	93	109	289	35	290	159	180	190	90	13,0	3	56	10,20
5	125	F 07	56	128	115	120	315	35	312	187	210	216	90	13,0	3	60	12,70
6	150	F 10	56	157	147	136	351	40	312	216	240	241	125	17,0	3	66	17,30
8	200	F 10	60	197	188	163	408	40	416	270	295	298	125	17,0	3	76	27,00
10	250	F 12	68	246	236	200	480	50	508	324	350	362	150	22,0	3	90	41,50
12	300	F 12	78	295	284	233	553	50	575	375	400	432	150	22,0	3	110	60,50
14	350	F 14	92	335	322	265	640	60	640	413	460	476	175	44,4	4	70	108,00
16	400	F 14	102	387	374	305	725	60	720	470	515	540	175	44,4	4	70	137,50
18	450	F 16	114	430	415	320	780	80	750	533	565	578	210	44,4	4	70	153,90
20	500	F 16	127	484	467	366	876	80	830	584	620	635	210	44,4	4	70	256,00
24	600	F 25	154	578	558	415	990	90	960	692	725	749	300	63,5	5	76	395,00

8	200	for PN 16 > DN 150	295						
10	250		355						
12	300		410						

Dimensions Head Flange

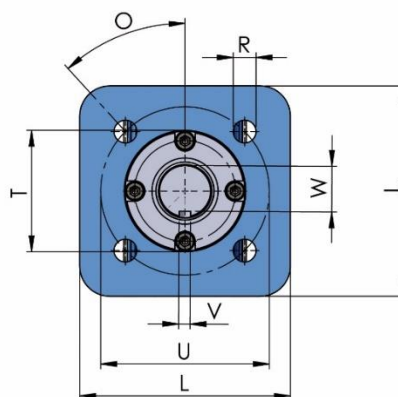
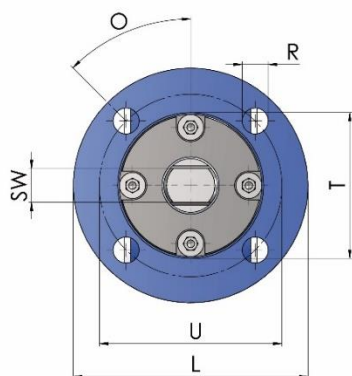
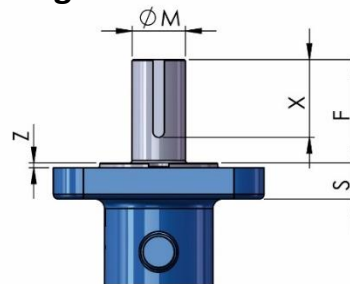
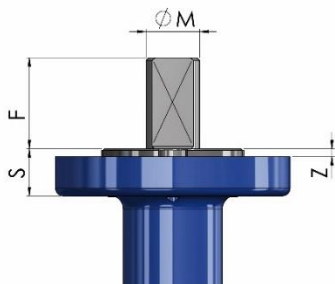

DN		Head flange	F	SW	L	ØM	O	nxR	S	U	T	Z	V	W	X
Inch	mm														
2 / 2½ / 3	50 / 65 / 80	F 05	35	10	65	14,2	45°	4x7	15	50	35	3			
4 / 5	100 / 125	F 07	35	13	90	20,5	45°	4x9	18	70	55	3			
6 / 8	150 / 200	F 10	40	17	125	25,3	45°	4x11	18	102	70	3			
10 / 12	250 / 300	F 12	50	22	150	32,4	45°	4x13	21	125	85	3			
14 / 16	350 / 400	F 14	60		175	44,4	45°	4x17	34	140	100	4	9,5	39	55
18 / 20	450 / 500	F 16	80		210	44,4	45°	4x22	44	165	130	4	9,5	39	55
24	600	F 25	90		300	63,5	22,5°	8x17	60	254	200	5	16,0	54	70

Dimensions Hand-Lever

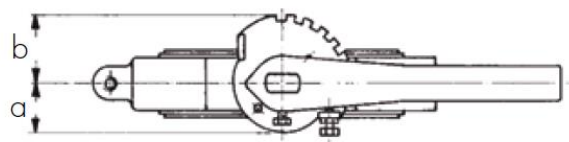
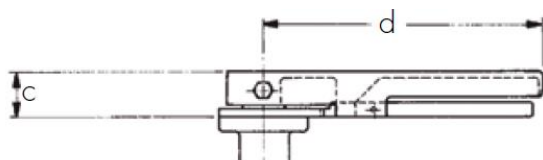

DN		a	b	c	d	Gew. Kg
Inch	mm					
2 / 2½ / 3	50 / 65 / 80	32,5	45	38	210	1,00
4 / 5	100 / 125	45	57	38	300	1,50
6 / 8	150 / 200	80	80	43	500	3,50

Dimensions Gear Operator

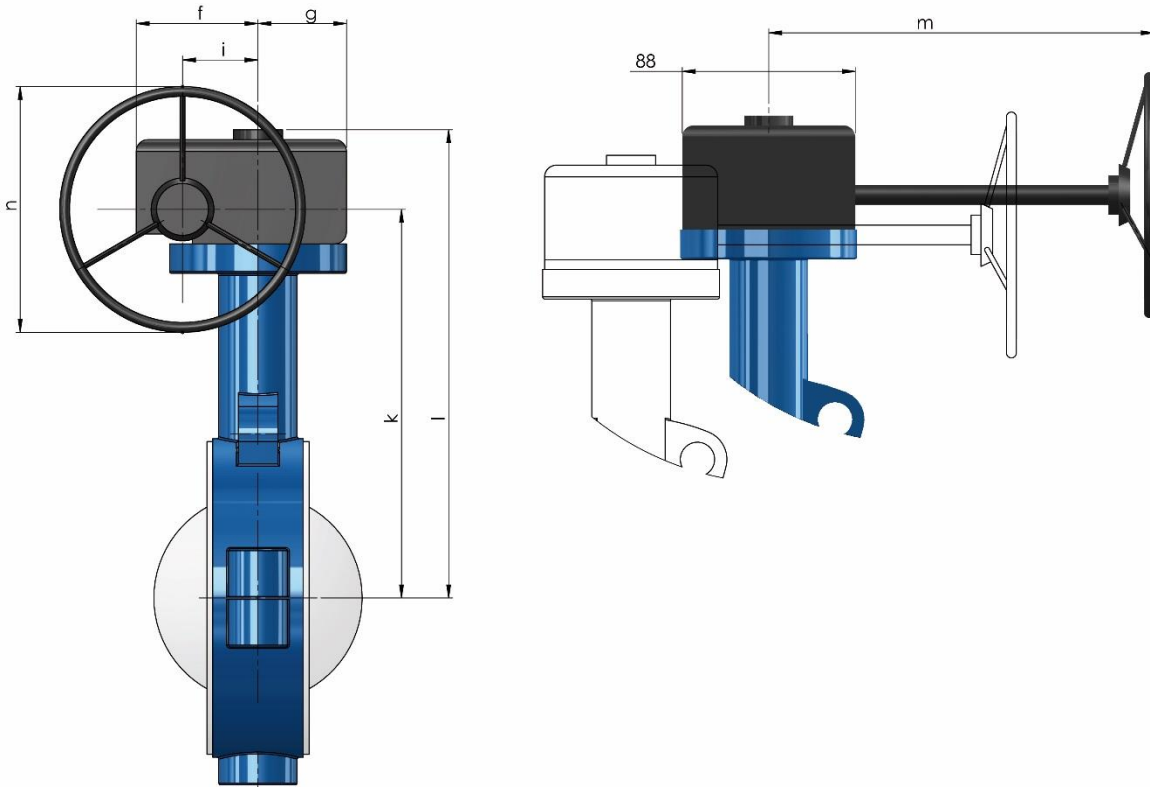

DN		f	g	h	i	k	l	m	n	Weight	Weight
Inch	mm									Kg (W)	Kg (L)
2	50	62	45	88	38,5	166,5	198	152	125	6,60	7,40
2½	65	62	45	88	38,5	167,5	208	152	125	7,60	8,30
3	80	62	45	88	38,5	191,5	223	152	125	8,00	10,50
4	100	62	45	88	38,5	206,5	238	152	125	10,10	14,20
5	125	62	45	88	38,5	221,5	253	152	125	12,60	16,60
6	150	83,5	58	116	52,0	250,0	282	182	250	18,00	22,90
8	200	83,5	58	116	52,0	280,0	312	182	250	23,20	29,20
10	250	105	75	150	66,7	322,0	361	216	300	38,20	47,90
12	300	105	75	150	66,7	362,0	401	216	300	47,10	63,50
14	350	131	86	198	89,5	425,0	468	283	450	89,00	120,00
16	400	131	86	198	89,5	470,0	513	283	450	106,70	149,20
18	450	178	114	252	123,0	510,0	568	335	450	152,40	180,90
20	500	178	114	252	123,0	560,0	611	335	450	184,30	274,80
24	600	209	117	315	154,0	625,0	702	360	450	289,20	427,70